

REPLACEMENT FLOORING

A Cost-Effective Option to a New Walk-in Cooler/Freezer

Replace damaged or worn-out floors in your cooler/freezer or convert a cooler unit to a freezer with our drop-in floor panels.*

- Improves efficiency
- Saves on energy costs
- Ends product loss caused by temperature fluctuations
- Extends the life of the unit
- Installs quickly without disassembly

Our replacement, or drop-in, floor panels are 1" smaller than the existing inside dimensions of the cooler/freezer. The ½" gap around the perimeter is filled with spray foam, then covered with the cove base.

OPTIONAL: Interior or exterior ramps

**Meets 2009 Federal Energy Independence & Security Act Requirement*

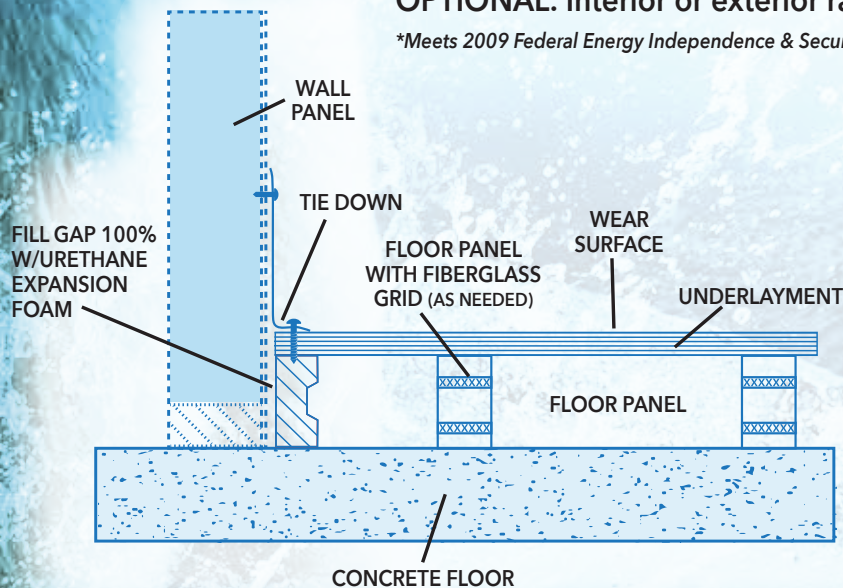

ArticTemp
WALK-IN COOLERS & FREEZERS

www.ArticTemp.com

- | | | | |
|---|---|---|---|
| ◀ West Coast Factory | ◀ Southwest Factory | ◀ East Coast Factory | ◀ Midwest Factory |
| 198 SE 223rd Ave.
Gresham, OR 97030
Phone: 800-238-4093 | 3350 E. Medina Rd.
Tucson, AZ 85756
Phone: 800-238-4093 | 209 Long Meadow Dr.
Salisbury, NC 28147
Phone: 800-438-2316 | 2115 W. Main St.
Prague, OK 74864
Phone: 800-289-2784 |